

SHARP

MX-6070N MX-5070N

Digital Full Colour Multifunctional System



Ramp Up Your Business with
a Smart and Productive MFD



simply better **business**

Fast, Full-Function Colour MFDs for Simply Better **Business**

Add new value to your office workflow and give your business a boost with Sharp's next-generation full-colour MX-6070N/5070N MFDs. State-of-the-art technology and fast output speeds of 60/50 ppm help to get your document jobs done quickly and smoothly. And user-friendly features—in particular, the intuitive Easy UI mode—make it easy for a wide range of users to operate the MFD and enjoy advanced document functionality.



Home screen

Simply Better **Process**

Business owners / directors

Transform the way you use information in your business by connecting one of these new MFDs to a variety of mobile devices and cloud services. Now you don't have to be confined to the office—you and your team can work anytime, anywhere. The amazing flexibility of these Sharp MFDs can help you grab new business opportunities and boost your bottom line.



Link to Public Cloud and Mobile Printing Services*

These MFDs enable single sign-on for easy access to public cloud services such as Google Drive™, OneDrive® for Business, and SharePoint® Online. They also support various mobile printing services such as the Android™ printing framework, Google Cloud Print™, AirPrint, and Mopria™.

* For details, see pages 5 and 6.

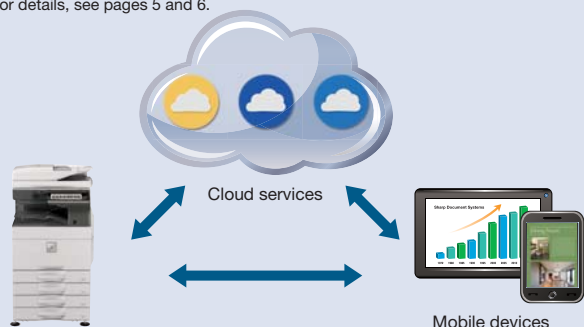

Convert Documents via OCR

OCR capability on the MX-6070N/5070N lets you convert a scanned document into a searchable PDF file or into an editable Microsoft® Word, PowerPoint®, or Excel® file. This means you can do speedy text searches, even with large-volume documents, and you can easily copy and paste text data into other applications. Functions like these help you maximise work efficiency.

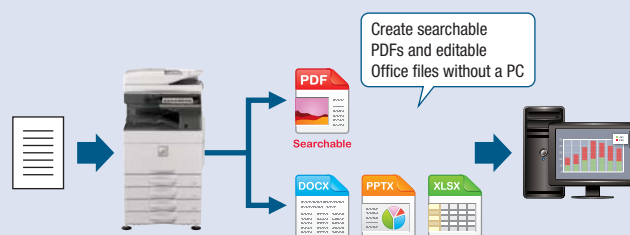

Simply Better Experience

Office users

Sharp's proprietary technologies give each of these MFDs quick warm-up and first copy times. A motion sensor—a first for a Sharp MFD—lets you use the machine without feeling like you have to wait. Thanks to their intuitive operation and superb usability, the MX-6070N/5070N simplify even the most complex work processes and help you finish document jobs fast.



Easy User Interface

The intuitive Easy UI mode makes it easy for anyone to use the MFD's advanced functions. In this mode, simple function icons are displayed on the 10.1-inch colour LCD touchscreen. Each user can customise the home screen by drag-and-dropping icons for commonly used functions, making for smoother, more efficient operation.

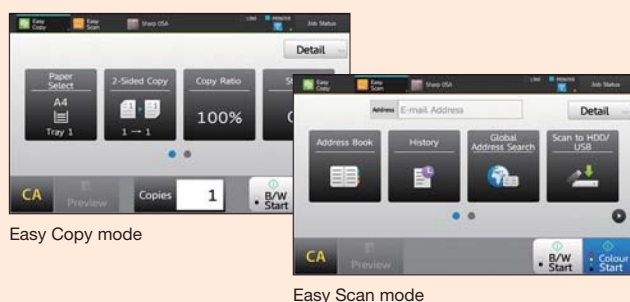

Motion Sensor

A built-in motion sensor detects your approach to the MFD and wakes it from Sleep mode. The control panel lights up and the machine finishes warming up as you enter your desired copy or scan settings. Then, with a minimum of waiting, you simply push the Start button to get the job underway.

Note: Detection range can be set to three different ranges.



Simply Better Admin

IT managers / administrators

These MFDs fit securely and seamlessly into your office system. An advanced security environment and new, easily viewable administration tools reduce the workload for system administrators and give full support to their management duties.



Secure Access Control

The MX-6070N/5070N support the **Active Directory®** service, which lets you use the machine's log-on credentials for internal network folders. System administrators can easily keep track of user credentials, which makes for an efficient and highly secure operational environment. And with **single sign-on**, you can access internal network folders by simply logging into the MFD—there's no need to re-enter your IDs and passwords.

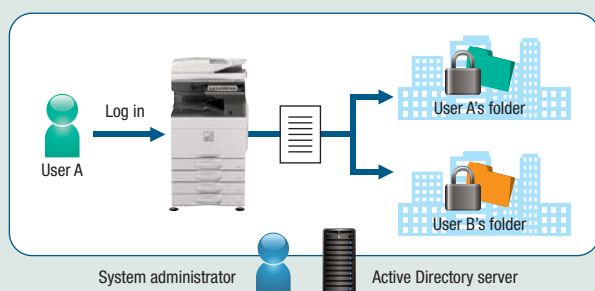

Integrated Device Management

As a system administrator, you can get the most out of a Sharp document system by using Sharp's efficiency-boosting device management tools. From a single location, you can use Sharp Remote Device Manager* (SRDM) to manage multiple Sharp MFDs. This includes everything from system setup, user access, and security settings to troubleshooting and maintenance. It's quick. It's effective. And it takes the hassle out of MFD management.

* Contact a Sharp customer representative for availability and other details.

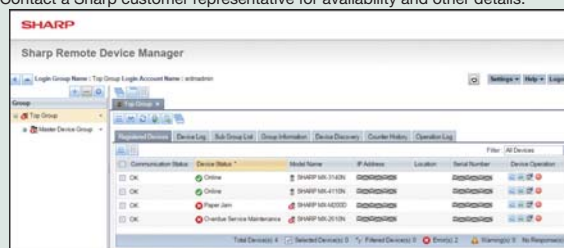

Sharp Remote Device Manager

EASE OF USE

The smartly designed MX-6070N/5070N set the standard for usability. Ergonomic and intuitive features ensure everyone can enjoy stress-free operation of the MFD.

10.1-Inch Colour LCD Touchscreen

A user-friendly touchscreen interface incorporating a new Easy UI mode makes it easy and intuitive to operate the MFD. The Advanced Preview function, meanwhile, lets you check document finishes and page layout in advance, edit pages easily, and preview documents in various modes.



Preview mode (3D)



Edit mode (rotate)

Easy Printing/Scanning with USB Drives

Insert a USB drive into the MFD and a print/scan command screen will automatically pop up on the LCD. Right away you can print files from the USB drive—which are displayed as thumbnails—or you can scan documents directly to the USB drive.



New Printer Driver with Easy Setup

The printer driver setup window features an improved design that includes larger buttons and drop-down menus, making it easier than ever to use printer functions.

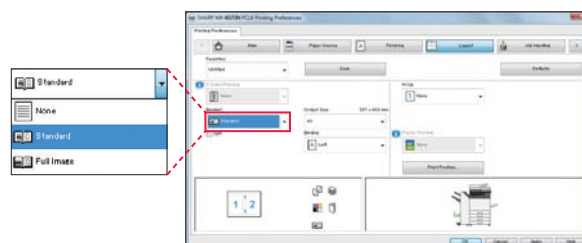

LED Status Lamps

Next to the control panel are two LED lamps: one red, one green. These light up to notify you—even from a distance—of the status of the machine.

3 LED lamp modes

Job status mode

Machine status mode

Accessibility mode*

* Indicates whether documents have been properly set in the document feeder



Universal Design

Free-Tilting Control Panel

The control panel can be tilted freely at various angles for easy viewing and easy operation, even from a wheelchair. Having the control panel at the perfect viewing angle means you can reduce eye strain and avoid making input errors.



Lock-on Handles

The paper drawers on these MFDs feature easy-grip, lock-on handles. As well as enabling easy opening and closing, they ensure that the paper drawers close properly, thereby enhancing safety in the event of a disaster such as an earthquake.

Remote Operation*

The Remote Operation function lets you display the MFD's main control panel on the screen of your PC or mobile device. From a remote location, you can then check MFD settings or reprint data stored on the MFD. This function also enables the administrator to guide an MFD user through necessary procedures and allows remote MFD operation from a wheelchair.

* Requires VNC application. Simultaneous remote operation from two or more PCs or mobile devices is not possible. Remote operation also depends on the network environment and applications being used. Contact a Sharp customer representative for details.

Utility Table

An optional Utility Table gives you a handy place to lay documents or a mobile device such as a tablet when you're working at the MFD. An IC card reader* can be installed underneath the table.



* Commercially available

When it comes to image quality, the MX-6070N/5070N deliver a reliably excellent performance. Thanks to their outstanding precision and colour quality, these MFDs lend your documents a beautifully professional look.

Easy, High-Quality Copying and Scanning

Through an advanced three-step process, **Auto Colour Mode** provides fully automated copying and scanning in both colour and B/W—with a simple press of the Start button. Here's how it works: **Auto Colour Selection** automatically determines whether a page is colour or B/W. **Auto Original Type Selection** then analyses page contents to distinguish between different components (such as photos and text) and selects the appropriate mode. Finally, **Background Suppression** automatically removes unnecessary background colour.

Auto Colour Mode

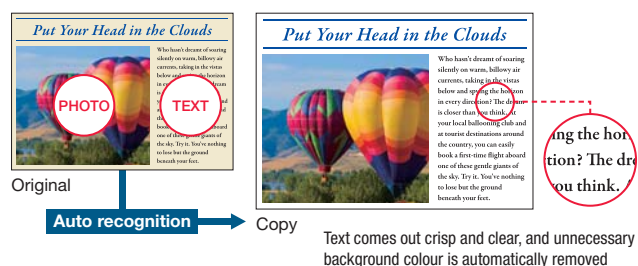

Developer Refresh System

By discharging old developer little by little and continuously replacing it with new developer, this system prevents developer deterioration and ensures stable print quality over the long term.

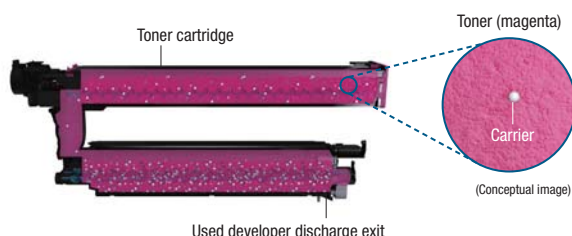

PCL 6 and True Adobe® PostScript® 3™

For improved graphics handling and enhanced font compatibility, these MFDs come standard with both PCL 6 and true Adobe PostScript 3. In addition, the PostScript driver allows you to use the dot screening technique so that you can emulate the high-quality printing of commercial offset printers.

High-Resolution Output

Each MFD's print engine supports 1,200 × 1,200 dpi printing and copying*. Digital smoothing technology enhances the print and copy resolution to the equivalent of 9,600 × 600 dpi, giving you ultra-clear image quality. Fine lines and small text come out looking crisper and easier to read.

* Copying in B/W only.

Improved Colour Reproduction

By thoroughly revamping the imaging process, Sharp was able to expand the colour gamut for these MFDs. As a result, colour reproduction is more faithful and vivid compared to previous models.

Colour Gamut Chart

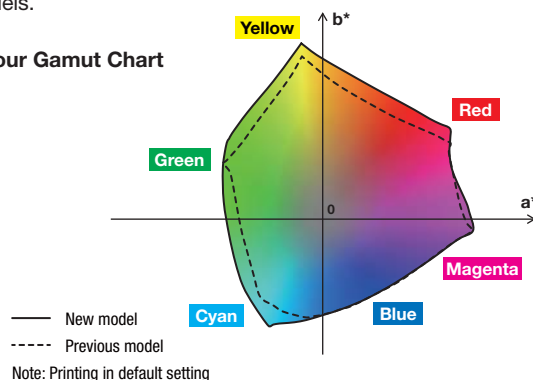

Auto Process Control

To maintain consistently high image quality during large-volume print jobs, these MFDs employ an enhanced periodic colour calibration system. Image density sensors read high-density and halftone colour patches and feed the information back to the image control unit. The MFD can then make adjustments to minimise colour variance between pages.

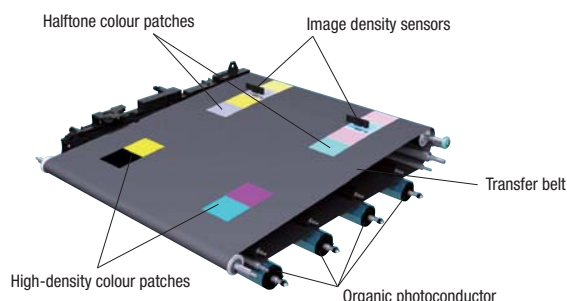

Line Width Adjustment

This function adjusts the width of lines. Fine lines, which are otherwise difficult to render properly, turn out sharp and crisp. Intricate line drawings, complex graphs and charts, and detailed spreadsheets are reproduced with exceptional quality and precision.

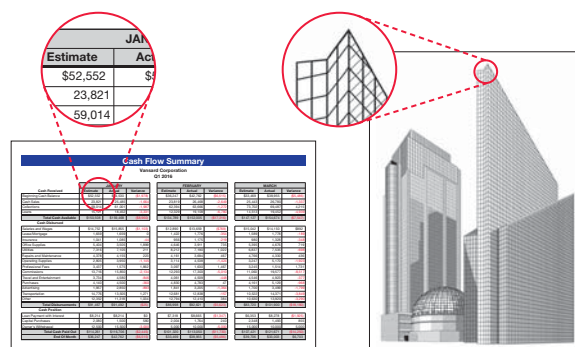

SECURE INFORMATION SHARING

Whether you're in the office or out and about, being able to share information easily and securely is vital to the smooth running of your business. Secure information sharing with a Sharp MFD transforms your working style and helps you grab new opportunities before they pass.

Link to Cloud Services*

An MX-6070N/5070N doesn't just connect to your local server. It also connects with cloud services directly from the MFD's control panel. You can upload scanned data to Google Drive, OneDrive for Business, or SharePoint Online—or print directly from any of them. Using a cloud service like this can save you the time and cost of setting up and managing a server within your company. Once you log into the MFD, you can quickly access multiple software services without having to sign in to each one separately. It's a true time-saver that gets your document jobs finished faster.

* Requires optional MX-AMX2.

Link with Mail Servers

Scanned data can be conveniently sent via your regular Gmail™ or Microsoft Exchange account. Sending e-mail is as easy as choosing a recipient from your address book on the mail server. Scanned data that you send can be stored on the mail server with other sent items.

Sharp OSA* (Open Systems Architecture)

Innovative Sharp OSA technology allows you to interact with critical business and network applications right from the LCD control panel, offering a new realm of control and convenience. And since Sharp OSA utilises industry-standard network protocols, the MX-6070N/5070N can easily integrate with document management systems, enterprise resource planning software, workflow applications, and more. The latest version of Sharp OSA can reach beyond the firewall, enabling extensive system construction as well as services delivered over the Internet such as cloud services.

In this way, Sharp OSA provides a foundation for cost reductions and information sharing across the entire company organisation—effectively enhancing total business efficiency.

* Requires optional MX-AMX2 and/or MX-AMX3.

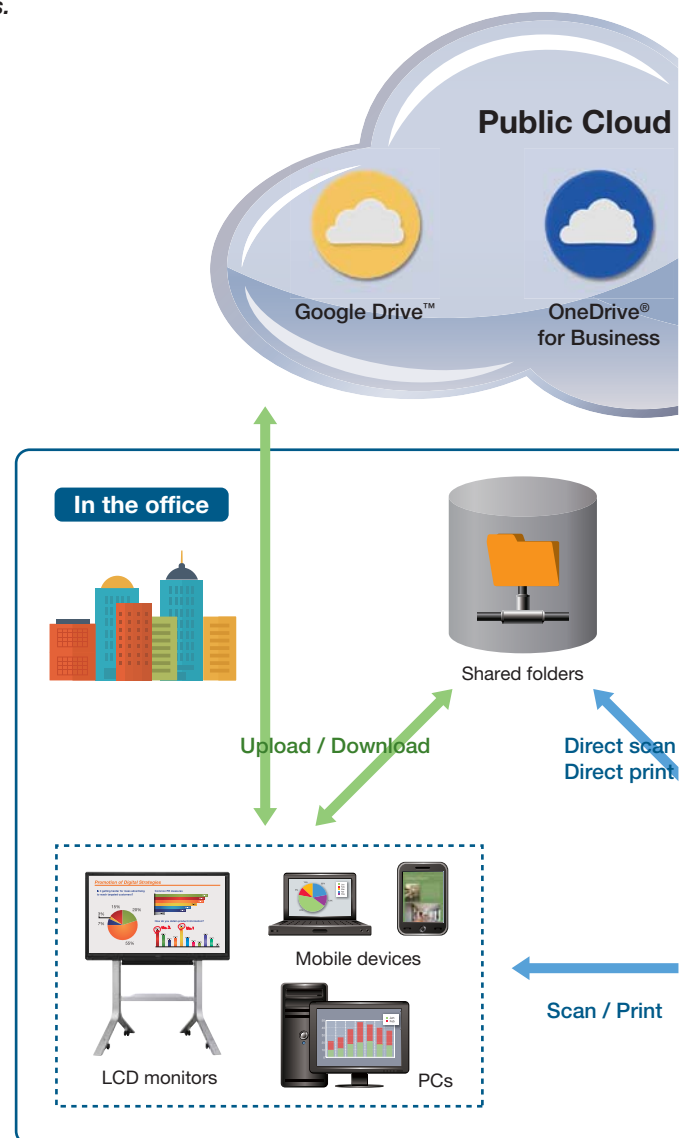

Multi-Layered Security

Sharp's powerful data security solutions protect your business assets and give you peace of mind. These MFDs safeguard your sensitive data by employing multiple levels of security functions covering a broad range of network and data security needs.

Network Security and Access Control

- **S/MIME** provides secure e-mail communications*
* When sending e-mail only.
- **SSL** (secure sockets layer) and **IPsec** data encryption technologies ensure secure network communications
- **User Authentication** covering up to 1,000 users prevents unauthorised MFD use by requiring access passwords
- **Active Directory** enables integrated management of user credentials, thereby providing a highly secure and efficient environment for system administrators

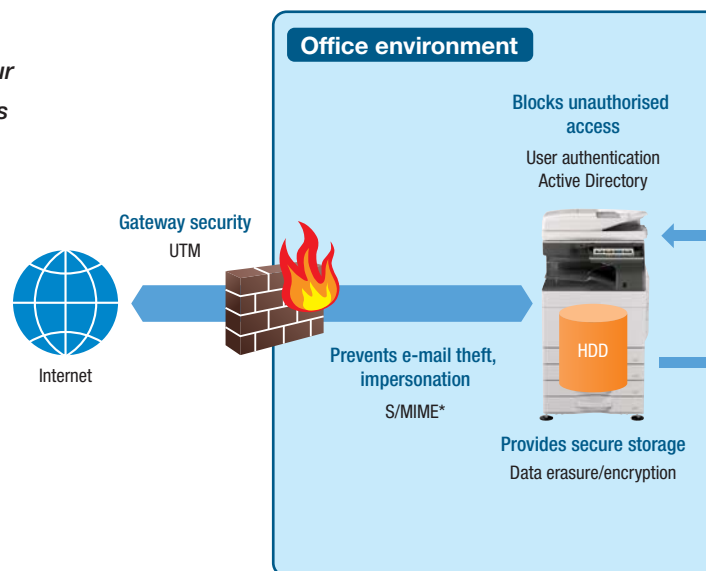

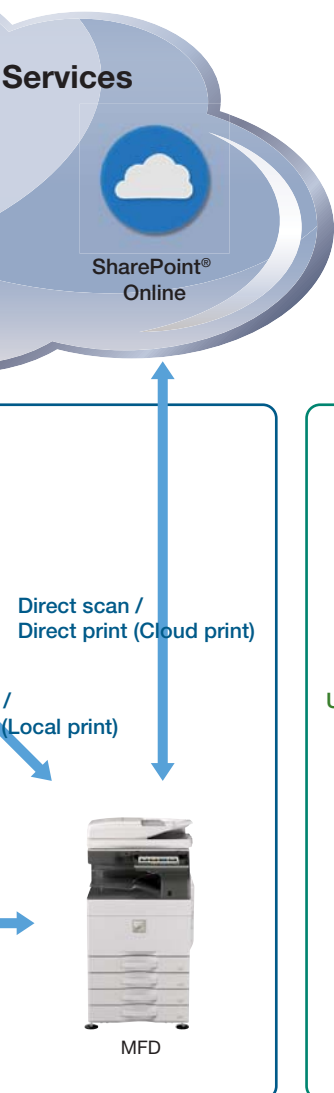

Two-Way Sharing with Mobile Devices

Connecting an MX-6070N/5070N to one or more mobile devices is easy, and it expands your options for sharing data. Not only can you send scanned documents to mobile devices such as smartphones and tablets, you can also print documents or photos sent from those devices.

Sharpdesk Mobile

Sharpdesk Mobile is a mobile print/scan application that connects the MFD to mobile devices via wireless LAN.

Mobile Printing Services

These MFDs support various mobile printing services such as the Android printing framework, Google Cloud Print, AirPrint, and Mopria.

Wireless Connections

These MFDs offer ultra-handry wireless access via two easy modes, enabling convenient access to the MFD even from places where a wired LAN is not available.

Infrastructure mode wirelessly connects the MFD to mobile PCs/devices via a commercially available wireless LAN router.

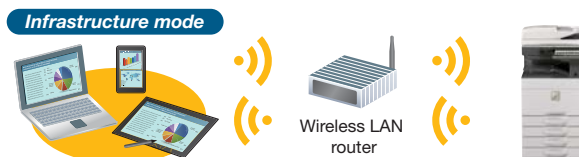

Access point mode wirelessly connects a LAN-wired MFD to mobile PCs/devices without going through a wireless LAN router.



Note: External networks cannot be accessed via the MFD. Up to five mobile devices can be wirelessly connected to the MFD at the same time.

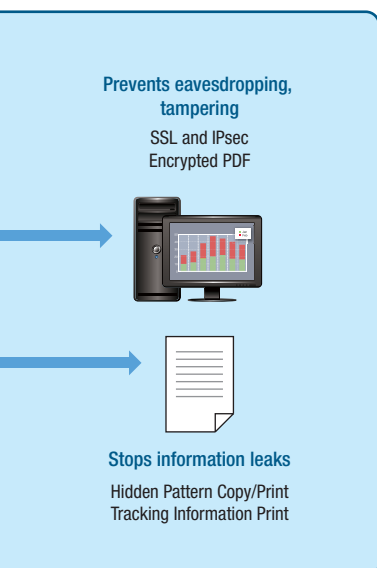

Document Protection

- **Document Control** prevents unauthorised use of confidential documents by embedding copy prevention data in them

Note: Requires optional Data Security Kit. May not work with certain types of paper, documents (such as those with a large volume of photos), or MFD settings.

- **Hidden Pattern Copy/Print** embeds a watermark, such as “Confidential” or “Not for Copy,” onto a document
- **Tracking Information Print** prints the MFD user’s name, the date, job ID, and other specifics on printouts, making it possible to track documents

Data Protection

- Job data is automatically **encrypted** before being saved to the MFD’s internal storage. Once a job is finished, its encrypted data is **erased** by up to 10 automatic overwrites

Note: Contact a Sharp customer representative for details on activating this function.

- Retained data can be **initialised** when it’s time to replace the MFD, preventing the leakage of confidential information

Whether a document job is big or small, you want to get it done quickly and efficiently. The superb performance of these MFDs promises you a smooth workflow and high productivity.

COPY/PRINT

Super-Efficient Colour and B/W Output

The MX-6070N/5070N deliver a fast output of 60/50 ppm* in B/W and in full colour. The first copy comes out in just 3.7 seconds in B/W and 4.8 seconds in full colour, saving you valuable time when performing multiple short-run jobs.

* A4, long-edge feeding

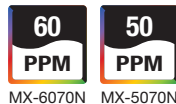

Print Release

The Print Release function lets you send documents to the main MFD, which acts as a server and stores them for printing out from any other MFD on the network. This function comes in handy when the main MFD is in use or under maintenance, letting you finish your job with minimal waiting.

Versatile Paper Handling

Maximum paper capacity on the MX-6070N/5070N is 6,300 sheets. Most of the paper trays accommodate a wide variety of paper, in sizes up to SRA3 and in weights up to 300 g/m². These MFDs can also handle extra-long paper up to 1,300 mm*. In addition to plain paper, the MFDs accommodate a number of other paper types, including coated, textured, embossed, and removable adhesive paper. Such versatile paper handling expands the range of possible printing applications.

* Sharp recommends using the optional MX-LT10 for this function. Please contact a Sharp customer representative for details.

Microsoft® Office Direct Printing

Print common Microsoft® Office files without using a PC. With a MX-6070N/5070N, you can print a Word, Excel®, or PowerPoint® file directly from a mobile device, cloud service, USB drive, or file server.

Note: This function is enabled via DirectOffice™ technology.



Intermediate Toner Hopper for Continuous Runs

Thanks to an intermediate toner hopper, there's no need to stop the MX-6070N/5070N during large-volume copy/print jobs when the toner cartridge needs changing.

The MX-6070N/5070N can use toner from the toner hopper to continue printing while the empty toner cartridge is replaced with a new one.



Job Separator Tray

The helpful Job Separator Tray option prevents copy/print/fax jobs from getting mixed together in the main tray by letting you send one of the job types to the Job Separator Tray.

Finisher Options

These MFDs offer plenty of finishing options to suit a variety of workplaces and applications.

	MX-FN27 Finisher	MX-FN29 Saddle Stitch Finisher	MX-FN31 Saddle Stitch Finisher
Max. paper capacity*1	500 sheets	1,000 sheets	3,000 sheets
Stapleless stapling	Yes	–	Yes
Manual stapling	Yes	–	Yes
Saddle stitching	–	Yes	Yes
Punching*2	Yes	Yes	Yes

*1: A4, 80 g/m², *2: Requires optional punch module

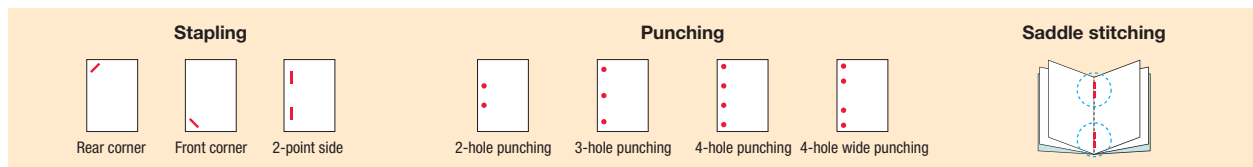

Stapleless Stapler

To make paper recycling easy and to save on stapler costs, a staple-free stapler crimps the corners of paper to keep up to five sheets securely bound.

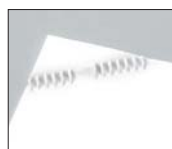

Manual Stapler

You can quickly staple documents at the MFD as needed without using a conventional stapler. A real time-saver if you want to, say, restaple documents that were unstapled for copying.



IMAGE SEND

High-Efficiency Scanning

Each MX-6070N/5070N comes equipped with a highly efficient 150-sheet DSPF (duplex single pass feeder). This scans both pages of two-sided documents in one pass. With a scanning speed of up to 100 opm* (one-sided) or 200 opm* (two-sided), these MFDs can finish even large projects quickly.

* Originals per minute; when feeding A4 sheets



Multiple Distribution of Scanned Files

Scanned documents can be distributed in a number of ways. For example, they can be sent as e-mail attachments or they can be scanned directly to an FTP server for storage. A standard-equipped compact PDF function ensures that PDF files are sent and received smoothly.

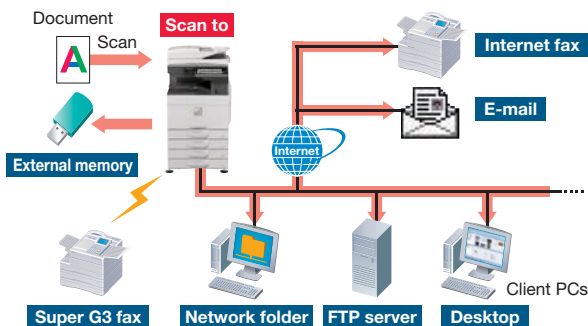

Improved Address Book

The address book has an improved layout that includes new Frequent Use buttons, a separate Address list, and larger buttons, scroll bar, and text. This user-friendly design makes selecting the right scan/fax destinations more effortless than ever.



Enhanced Scan Functions

Automated Scanning*

Using advanced optical character recognition, these MFDs can correct the vertical orientation of pages mixed in upside down. This conveniently saves you the hassle of having to rescan those pages. The MFDs can also automatically determine scan resolution and skip blank pages in a multi-page document.

* Easy UI mode only

Multicrop Function

The Multicrop function automatically creates separate files for multiple different-sized documents—such as receipts and bills—that are scanned simultaneously.

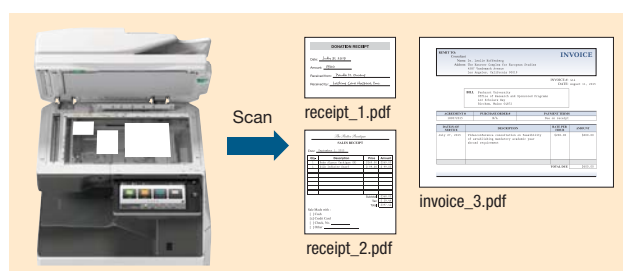

Business Card Management

It's easy to manage a database of business cards with the MX-6070N/5070N. The MFD reads contact details on each card via OCR and then exports those details to a third-party contact management system of your choice.

Versatile Fax Functions (option)

- **Super G3 Fax** function
- **Internet Fax** lets you economically send and receive faxes to and from other T-37-compliant Internet fax machines
- **PC-Fax** lets you send documents created on a PC directly to a recipient's fax machine via a phone line without printing to paper

Document Management

Document Filing

Document Filing allows processed data to be saved in designated folders on the MFD's hard disk. From there, it can be instantly recalled for printing and sending at a later time.

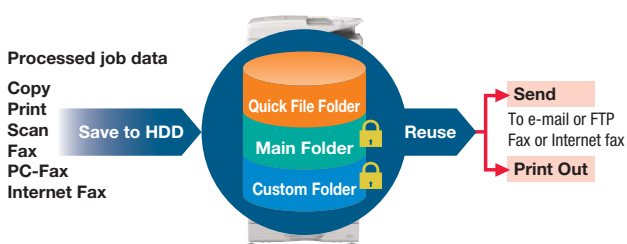

Sharpdesk

With Sharpdesk integrated document management software, scanned files can be organised, edited, converted, and combined with ease. What's more, Full Text Search makes it easy to retrieve your documents.

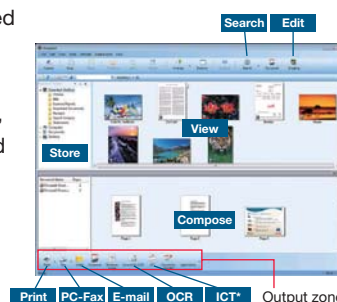

* Image Compression Tool for converting images into compact PDF files

ENVIRONMENT-FRIENDLY

With a view to minimising the environmental impact of its products, Sharp has applied its advanced technologies across all areas of these MFDs, including the hardware, firmware, electrical systems, and supplies.

Low TEC Value*1

In every respect, these MFDs have been designed to deliver exceptional energy efficiency. As a result, they boast a TEC value that is significantly lower than the maximum allowable values determined by ENERGY STAR®.

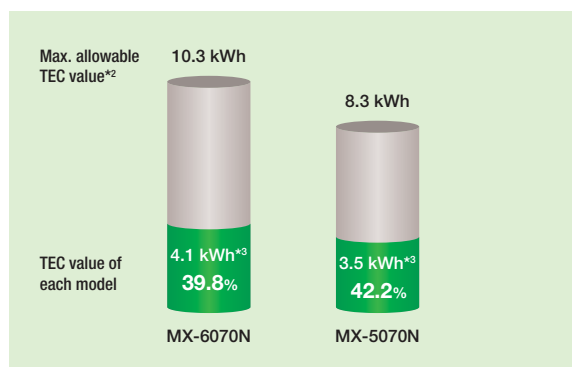

*1: Typical amount of energy consumed in a hypothetical week measured as stipulated under the ENERGY STAR programme.

*2: Maximum TEC value allowable under the latest ENERGY STAR programme (version 2.0).

*3: Measured at 230 V.

Quick-Heating Belt Fusing System

A newly developed quick-heating belt fusing system enables a short warm-up time of 10 seconds to reduce overall energy consumption.

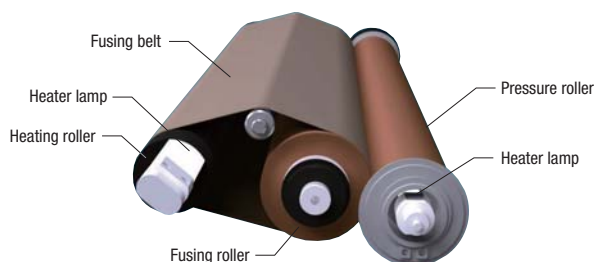

Eco Recommendation

This function suggests environmentally friendly settings before a print/copy command is executed from the control panel.

* For printing Document Filing data and direct printing (FTP/SMB/USB)

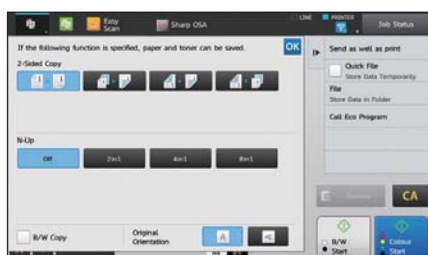

Eco Scan

The Eco Scan function saves energy by keeping the fusing system shut down during jobs that don't require its use—for example, during image sending and Document Filing.

Auto Power Shut-Off Mode

Based on prior usage patterns, the MFD automatically determines how long to wait before going into auto power shut-off mode. Shortly before this mode begins, a message appears on the LCD indicating that the MFD will soon shut down and giving you the option to continue operation.

Power ON/OFF Schedule

This function automatically turns the MFD on or off per administrator-set schedules.

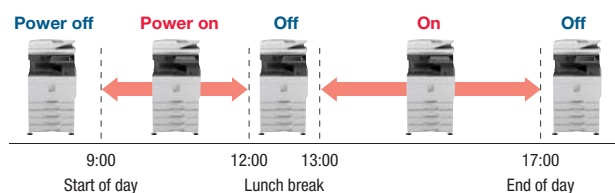

Eco-Friendly Toner

New Mycrostoner-Crystal is filled with low-melting-point material. Compared to a conventional toner, this toner is able to fuse at lower temperatures, resulting in reduced energy consumption.

Automatic Toner Cartridge Eject Function

This function expels completely empty cartridges in preparation for replacement. The cartridge is replaced only after all the toner has been consumed, thereby ensuring efficient use of toner. Because you can tell at a glance when cartridges are empty, they are fast and easy to replace.



System Configuration

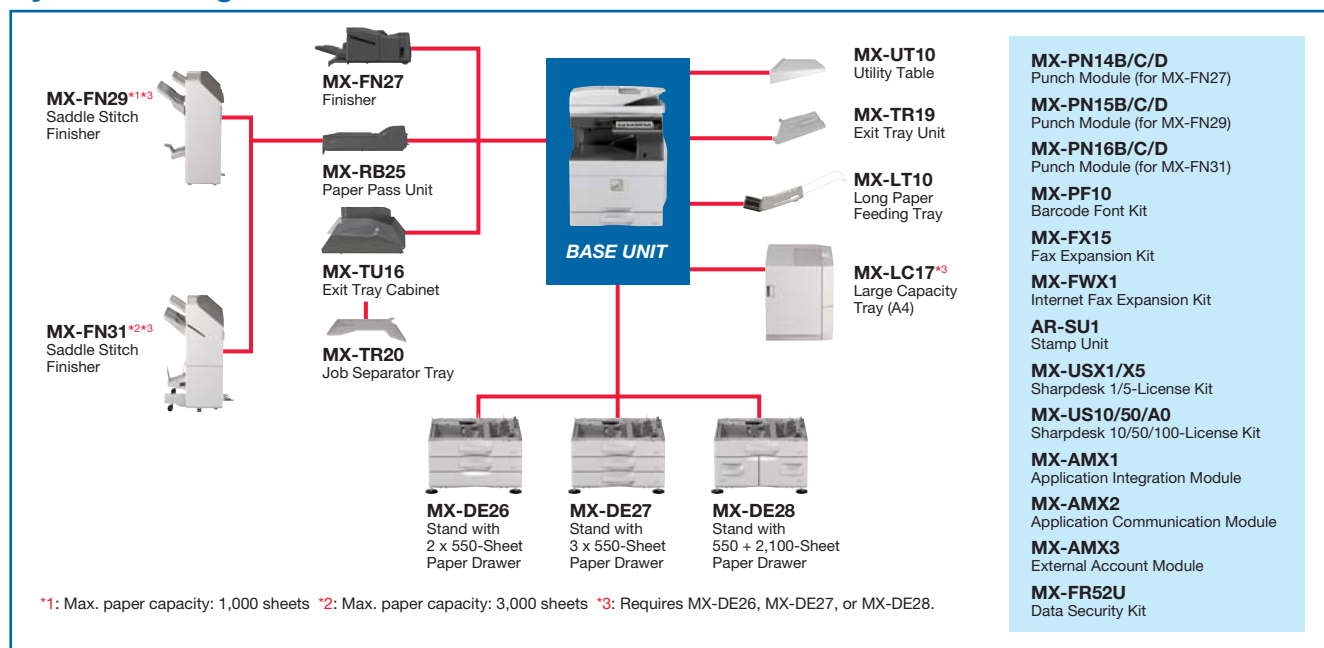

Specifications for Options

MX-TR20 Job Separator Tray

Paper size	SRA3 to A5
Paper capacity	100 sheets (A4)

MX-FN27 Finisher

Paper size	Non offset Offset/staple Stapleless staple	SRA3 to A5 A3 to B5 ^{*1} A3 to B5 ^{*2}
Paper capacity	Non offset/offset Staple	500 sheets (A4 or smaller), 250 sheets (B4 or larger) 30 sets or 500 sheets (A4 or smaller), 30 sets or 250 sheets (B4 or larger)
Stapling capacity	Stapleless staple Staple	30 sets 50 sheets (A4, B5 ^{*4}), 30 sheets (A3, B4)
Staple position	Stapleless staple Manual staple Staple mode Stapleless staple mode Manual staple mode	5 sheets ^{*3} Total paper thickness 4 mm or less (40 sheets) 3 locations (front, rear, or 2-point stapling) 1 location (rear) 1 location

MX-FN29 Saddle Stitch Finisher

Paper size	Non offset Offset Staple	SRA3 to A5 A3W to A5 A3W to B5
Paper capacity	Finishing tray (non offset/offset) (staple)	1,000 sheets (A4), 500 sheets (other sizes) 100 sets or 1,000 sheets (A4), 50 sets or 500 sheets (other sizes)
	Top tray Saddle stitch tray	250 sheets (A4 or smaller), 50 sheets (B4 or larger) 7 sets of 11–15 sheets, 10 sets of 6–10 sheets, 20 sets of 1–5 sheets
Stapling capacity		50 sheets (A4, B5), 30 sheets (A3, B4)
Staple position		3 locations (front, rear or 2-point stapling)

MX-LC17 Large Capacity Tray

Paper size	A4, B5
Paper capacity	3,000 sheets

MX-LT10 Long Paper Feeding Tray

Paper size	Max. 1,300 mm long
Paper capacity	1 sheet

MX-FN31 Saddle Stitch Finisher

Paper size	Non offset Offset/staple Stapleless staple	SRA3 to A5 A3 to B5 ^{*1} A3, A4 ^{*2}
Paper capacity	Finishing tray (non offset/offset) (staple) (stapleless staple) Top tray Saddle stitch tray	3,000 sheets (A4, B5), 1,500 sheets (other sizes) 200 sets or 3,000 sheets (A4, B5), 100 sets or 1,500 sheets (other sizes) 200 sets (A4), 100 sets (A3) 250 sheets (A4 ^{*3} , B5 ^{*3} , A5), 125 sheets (other sizes) 10 sets of 11–20 sheets, 15 sets of 6–10 sheets, 25 sets of 1–5 sheets
Stapling capacity	Staple Stapleless staple Manual staple	65 sheets (A4 ^{*3} , B5 ^{*3}), 30 sheets (other sizes) 5 sheets ^{*3} Total paper thickness 9 mm or less (65 sheets)
Staple position	Staple mode Stapleless staple mode Manual staple mode	3 locations (front, rear, or 2-point stapling) 1 location (rear) 1 location

Punch Modules

Model name	For MX-FN27	MX-PN14B ^{*6}	MX-PN14C ^{*7}	MX-PN14D
	For MX-FN29	MX-PN15B ^{*6}	MX-PN15C ^{*7}	MX-PN15D
	For MX-FN31	MX-PN16B ^{*6}	MX-PN16C ^{*7}	MX-PN16D
Number of holes		3	2 or 4	4 (wide)
Paper weight		55 to 300 g/m ² ^{*4}		

MX-DE26 Stand with 2 x 550-Sheet Paper Drawer

Paper size	Upper and lower tray	SRA3 to A5 ^{*5}
Paper capacity	Upper and lower tray	550 sheets each

MX-DE27 Stand with 3 x 550-Sheet Paper Drawer

Paper size	Upper/middle/lower tray	SRA3 to A5 ^{*5}
Paper capacity	Upper/middle/lower tray	550 sheets each

MX-DE28 Stand with 550 + 2,100-Sheet Paper Drawer

Paper size	Upper tray Lower right tray Lower left tray	SRA3 to A5 ^{*5} A4, B5 A4
Paper capacity	Upper tray Lower right tray Lower left tray	550 sheets 900 sheets 1,200 sheets

Note: All specifications relating to paper capacity refer to 80 g/m² paper.

^{*1}: Only long-edge feeding can be used with A4 and B5 paper. ^{*2}: Long-edge feeding. ^{*3}: Guaranteed stapleable weight is up to 64 g/m² (4 sheets up to 81.4 g/m² and 3 sheets up to 105 g/m²). ^{*4}: Guaranteed punchable weight is 60 to 128 g/m². ^{*5}: Only short-edge feeding can be used with A5 paper. ^{*6}: Accepts North American paper sizes. ^{*7}: Accepts ISO-standard paper sizes

SPECIFICATIONS

General

Type	Desktop
Engine speed	A4:*1 Max. 60/50 ppm A3: Max. 30/26 ppm SRA3: Max. 29/24 ppm
Control panel display	10.1-inch colour LCD touchscreen
Paper size	Max. SRA3, min. A5
Paper capacity (80 g/m ²)	Standard: 650 sheets (550-sheet tray and 100-sheet multi-bypass tray) Maximum: 6,300 sheets (650 sheets & optional 550 + 2,100-sheet tray and 3,000-sheet tray) Tray: 60 g/m ² to 300 g/m ² Multi-bypass tray: 55 g/m ² to 300 g/m ²
Paper weight	15 sec.
Warm-up time*2	5GB (copy/print shared) 500GB HDD*3
Memory	230-240 VAC, 50/60 Hz
Power requirements	2.07 kW
Power consumption	616 x 660 x 838 mm
Dimensions (W x D x H)*4	90 kg
Weight (approx.)	

Copier

Original paper size	Max. A3
First copy time*5	Full colour: 4.8 sec. B/W: 3.7 sec.
Continuous copy	Max. 9,999 copies
Resolution	Scan (colour): 600 x 600 dpi Scan (B/W): 600 x 600 dpi, 600 x 400 dpi, 600 x 300 dpi Print (colour): 600 x 600 dpi, 9,600 (equivalent) x 600 dpi (depending on copy mode) Print (B/W): 1,200 x 1,200 dpi, 600 x 600 dpi, 9,600 (equivalent) x 600 dpi (depending on copy mode)
Gradation	Equivalent to 256 levels
Zoom range	25 to 400% (25 to 200% using DSPF) in 1% increments
Preset copy ratios	10 ratios (5R/5E)

Network Scanner

Scan method	Push scan (via control panel) Pull scan (TWAIN-compliant application)
Scan speed*6 (colour & B/W)	One-sided: Max. 100 originals/min. Two-sided: Max. 200 originals/min.
Resolution	Push scan: 100, 150, 200, 300, 400, 600 dpi Pull scan: 75, 100, 150, 200, 300, 400, 600 dpi 50 to 9,600 dpi via user setting*7
File formats	TIFF, PDF, PDF/A, encrypted PDF, compact PDF*8, JPEG*8, XPS, searchable PDF, Microsoft® Office (pptx, xlsx, docx), text (TXT), rich text (RTF)
Scanner utility	Sharpdesk
Scan destinations	Scan to e-mail/desktop/FTP server/network folder (SMB)/ USB drive/HDD

*1: Long-edge feeding.

*2: At rated voltage, 23°C. May vary depending on operating conditions and environment.

*3: HDD capacity depends on procurement and sourcing status.

*4: Including adjusters and protuberances.

*5: Long-edge feeding of A4 sheets from 1st paper tray, using document glass, without Auto Colour Selection and Auto Colour mode, MFD in fully ready condition. May vary depending on operating conditions and environment.

*6: Based on Sharp's A4 standard chart, using document feeder and long-edge feeding. Using factory default settings with Auto Colour Selection off. Scan speed will vary depending on the type of document and the scan settings.

*7: Resolution may vary depending on the size of the scanned area.

*8: Colour/greyscale only.

*9: Storage capacity will vary depending on the type of document and the scan settings.

*10: Some features require option(s).

*11: Based on Sharp's standard chart with approx. 700 characters (A4 long-edge feeding) at standard resolution in Super G3 mode, 33,600 bps, JBIG compression.

Document Filing

Document filing capacity*9	Main and custom folders: 20,000 pages or 3,000 files
Stored jobs*10	Quick file folder: 10,000 pages or 1,000 files
Storage folders	Copy, print, scan, fax Quick file folder, main folder, custom folder (max. 1,000 folders)

Network Printer

Resolution	1,200 x 1,200 dpi, 600 x 600 dpi, 9,600 (equivalent) x 600 dpi
Interface	USB 2.0 (host, high-speed), 10Base-T/100Base-TX/1000Base-T
Supported OS	Windows Server® 2008, Windows Server® 2008 R2, Windows Server® 2012, Windows Server® 2012 R2, Windows Server® 2016, Windows Vista®, Windows® 7, Windows® 8.1, Windows® 10, Mac OS X 10.4, 10.5, 10.6, 10.7, 10.8, 10.9, 10.10, 10.11 Mac OS X 10.12, TCP/IP
Network protocols	LPR, Raw TCP (port 9100), POP3 (e-mail printing), HTTP, FTP for downloading print files, IPP, SMB, WSD
Printing protocols	PCL 6 emulation, Adobe® PostScript® 3™ 80 fonts for PCL, 139 fonts for Adobe PostScript 3
PDL	
Available fonts	

B/W Facsimile (optional MX-FX15 required)

Compression method	MH/MR/MMR/JBIG
Communication protocol	Super G3/G3
Transmission time	Less than 3 seconds*11
Modem speed	33,600 bps to 2,400 bps with automatic fallback
Transmission resolution	From Standard (203.2 x 97.8 dpi) to Ultra Fine (406.4 x 391 dpi)
Recording size	A3 to A5
Memory	1GB (built-in)
Greyscale levels	Equivalent to 256 levels

- Design and specifications are subject to change without prior notice.
- Colour variations to products may occur due to printing.
- Some features require Optional items. Please consult with an authorised Sharp Reseller for details.
- The ENERGY STAR logo is a certification mark and may only be used to certify products that have been determined to meet the ENERGY STAR programme requirements. ENERGY STAR and the ENERGY STAR mark are registered trademarks owned by the US Environmental Protection Agency. The ENERGY STAR guidelines apply to products only in the US, the EU, Japan, Canada, Australia, New Zealand, and Taiwan.
- Microsoft, Windows, Windows Server, Windows Vista, PowerPoint, Excel, Active Directory, SharePoint, and OneDrive are either registered trademarks or trademarks of Microsoft Corporation in the US and/or other countries. Mac OS and AirPrint are trademarks of Apple Inc., registered in the US and other countries. Adobe and PostScript 3 are either registered trademarks or trademarks of Adobe Systems Incorporated in the US and/or other countries. PCL is a registered trademark of Hewlett-Packard Company. Android, Google Cloud Print, Google Drive, and Gmail are trademarks of Google Inc. The Google Drive trademark is used with permission from Google Inc. Mopria is a trademark of Mopria Alliance, Inc. DirectOffice is a product of CSR Imaging US, LP. DirectOffice is a trademark of CSR Imaging US, LP, registered in the US

DIRECTOffice™

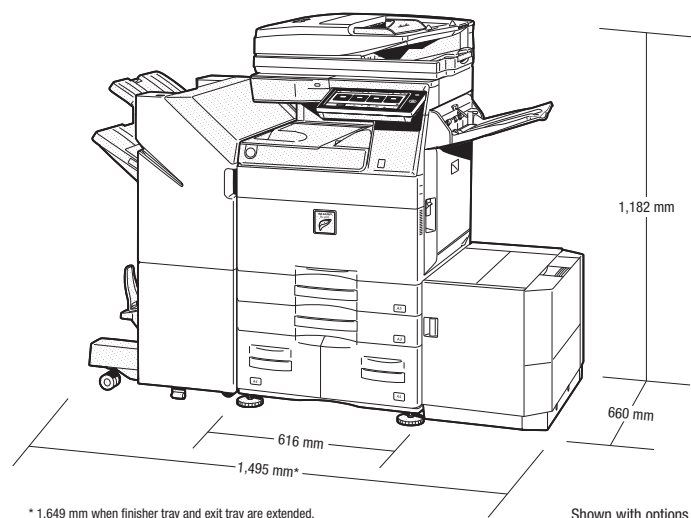

* 1,649 mm when finisher tray and exit tray are extended.

Shown with options.

Distributed by:

SHARP

SHARP CORPORATION OF AUSTRALIA PTY LTD
ABN 40 003 039 405
P.O. Box 84, Macquarie Park, NSW 2113
Tel: (02) 9830 4600
www.sharp.net.au

SHARP CORPORATION OF NEW ZEALAND LTD
59 Hugo Johnston Drive
P.O. Box 12244, Penrose, Auckland
Tel: (09) 573 0111 Fax: (09) 573 0112
www.sharp.net.nz